

GARBERS CHURCH ROAD RECONFIGURATION

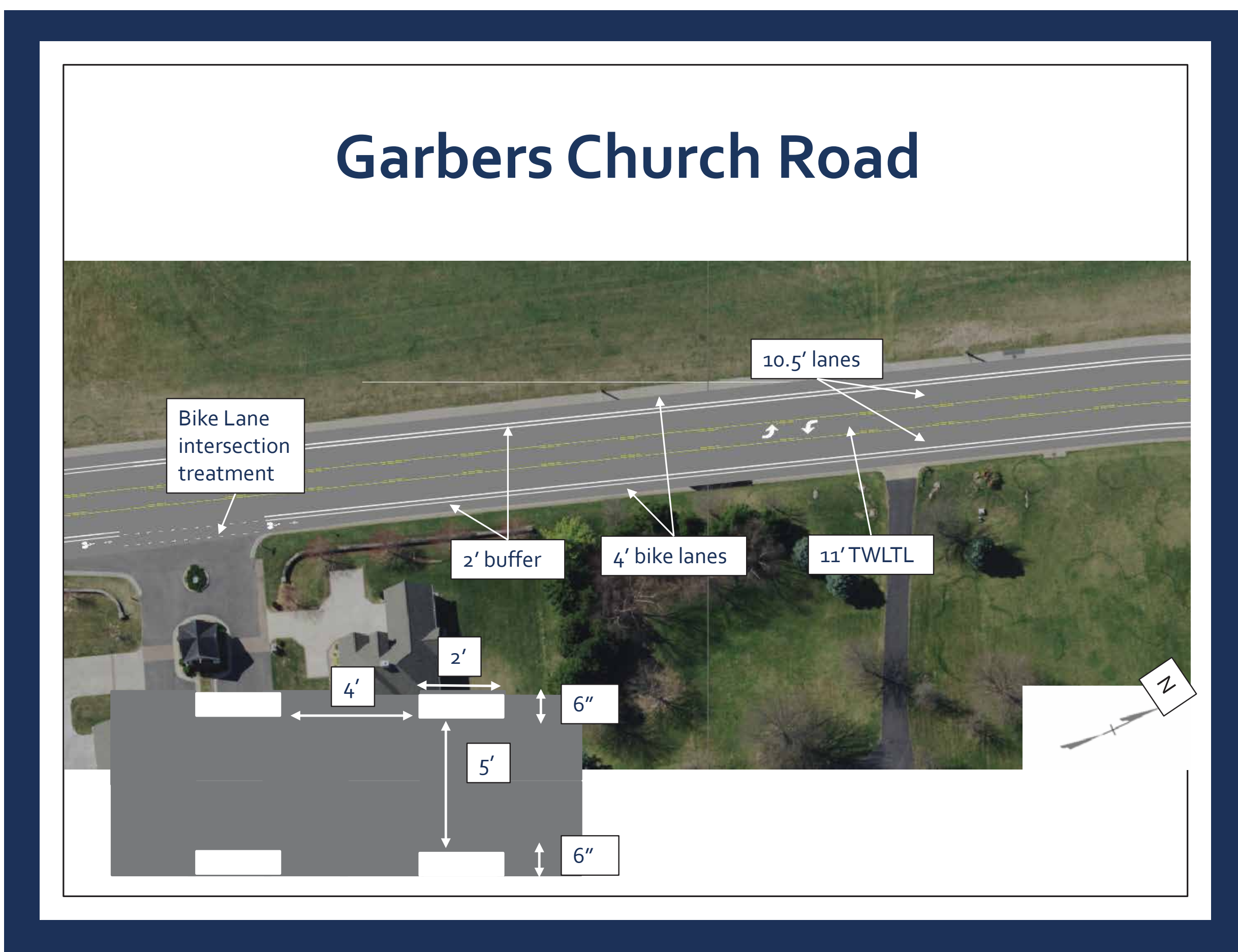

P
L
A
N
N
E
D

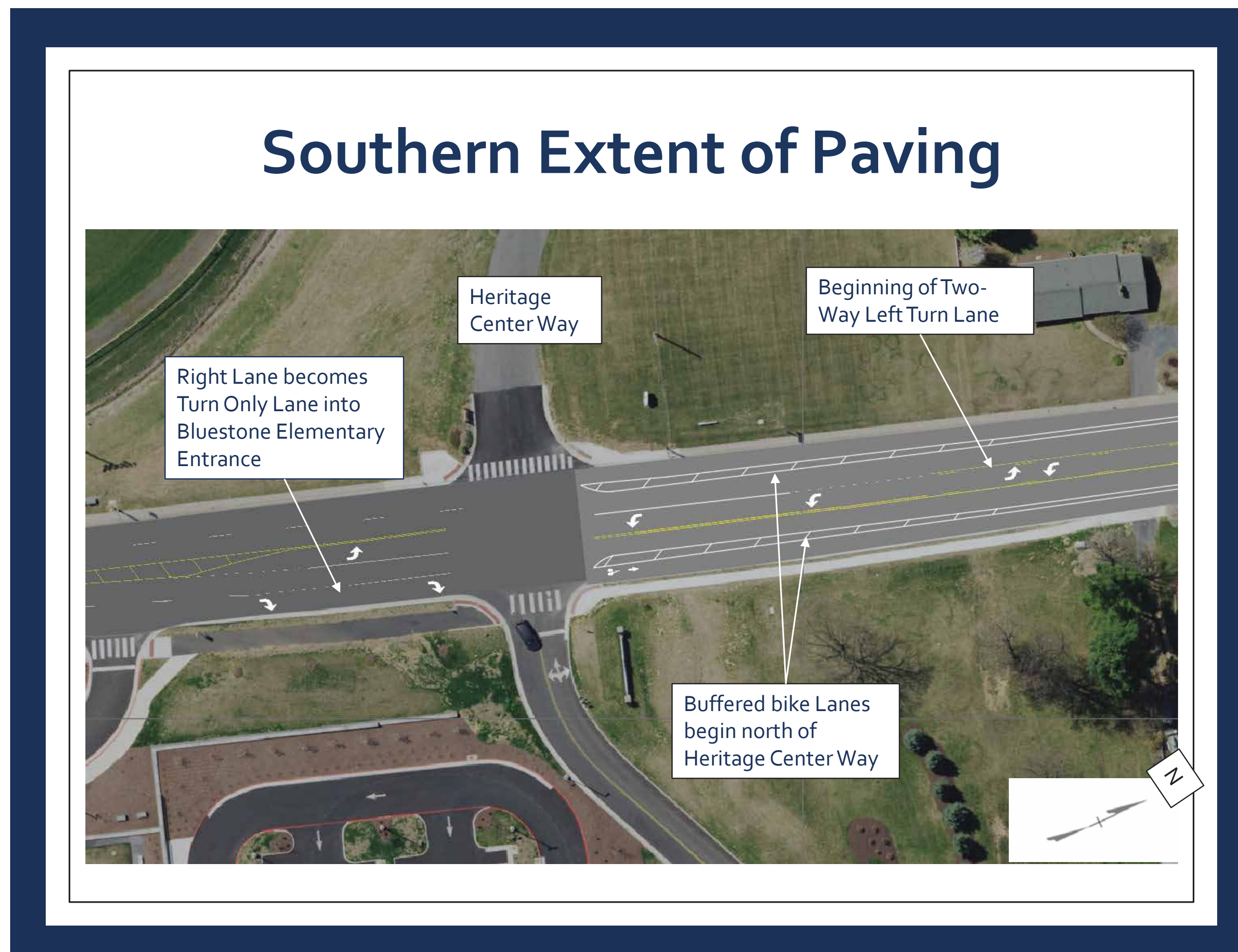
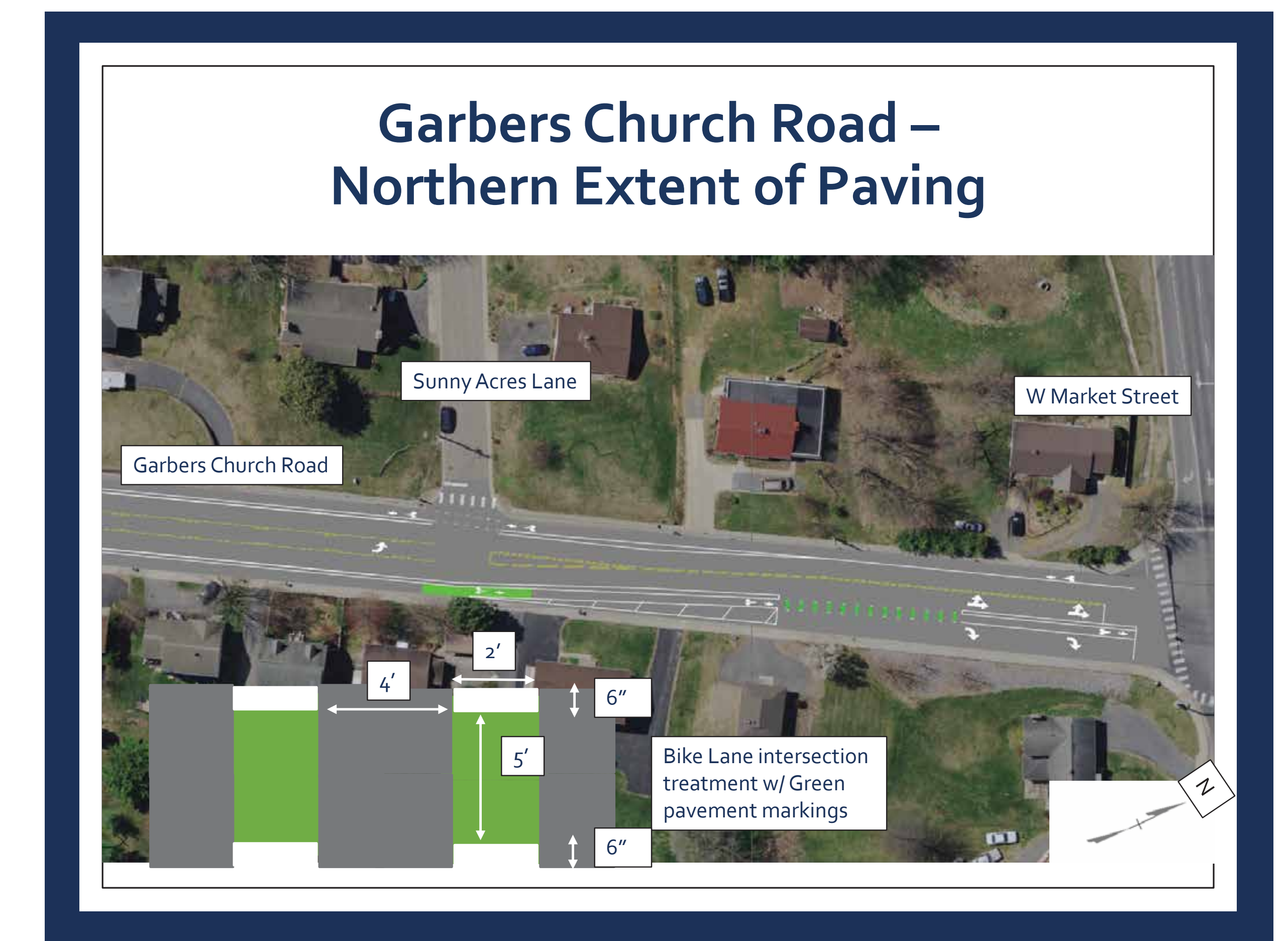
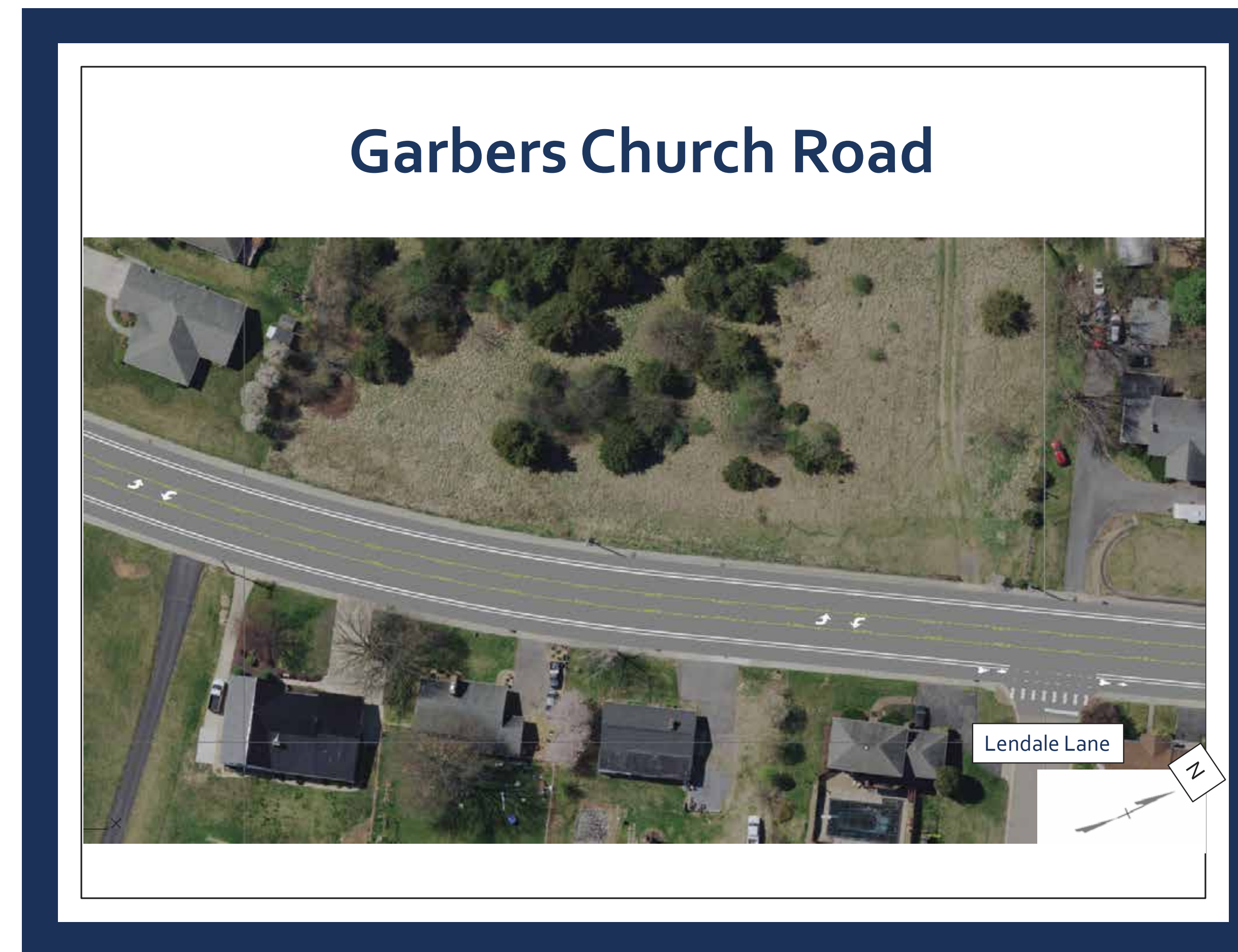

E
X
I
S
T
I
N
G

P
L
A
N
N
E
D

- Extension of the reconfiguration to Erickson Avenue will be considered in the coming years when the road is repaved.

- Creates a bicycle and pedestrian route connection to and from the Friendly City Trail.

- Creates safer routes to schools for local students and their families, staff, and faculty.

MOUNT CLINTON PIKE ROAD RECONFIGURATION

EXISTING

Mount Clinton Pike & Liberty Street - Existing



PLANNED

Mount Clinton Pike & Liberty Street - Planned

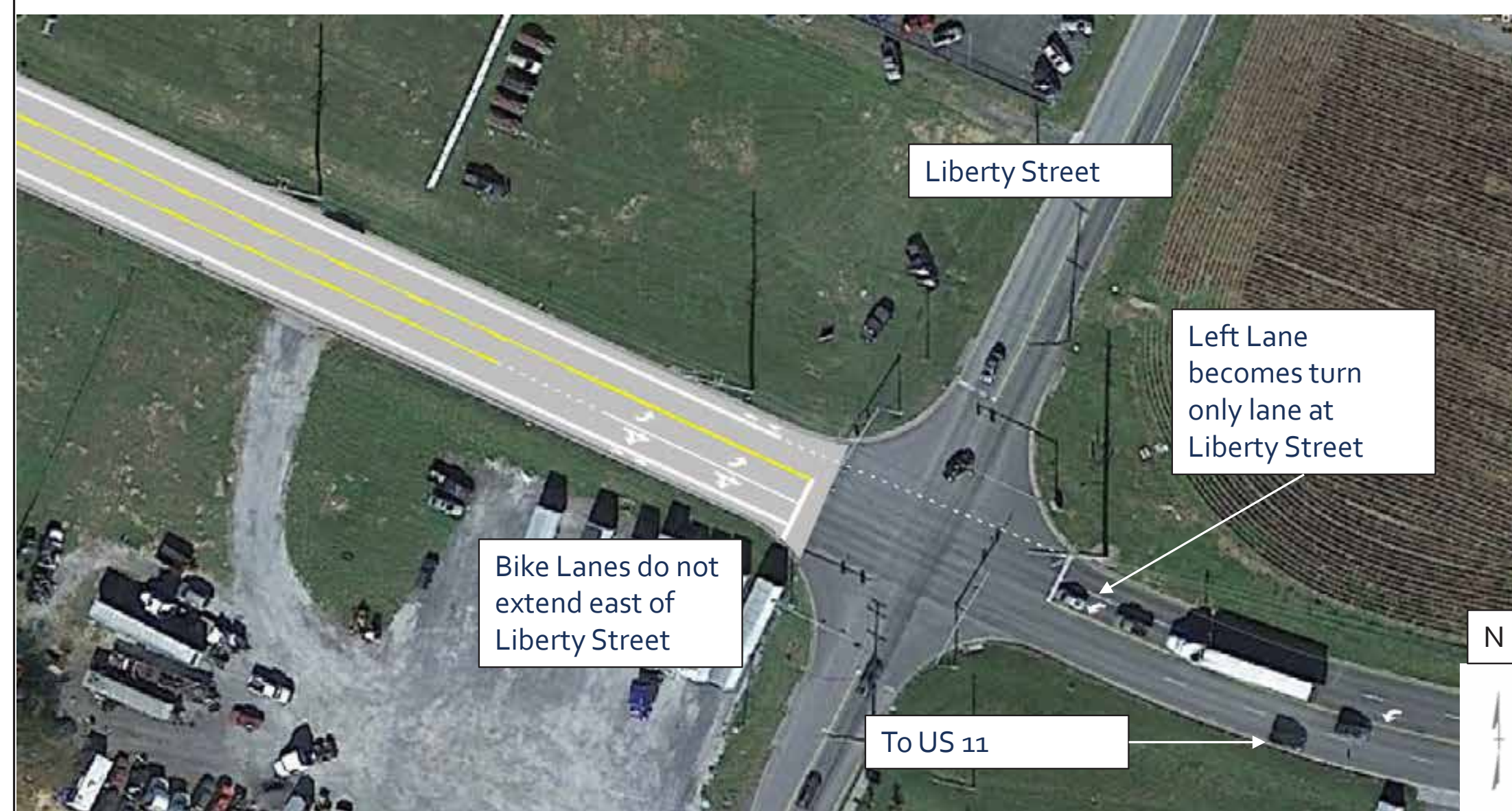

PLANNED

Mount Clinton Pike

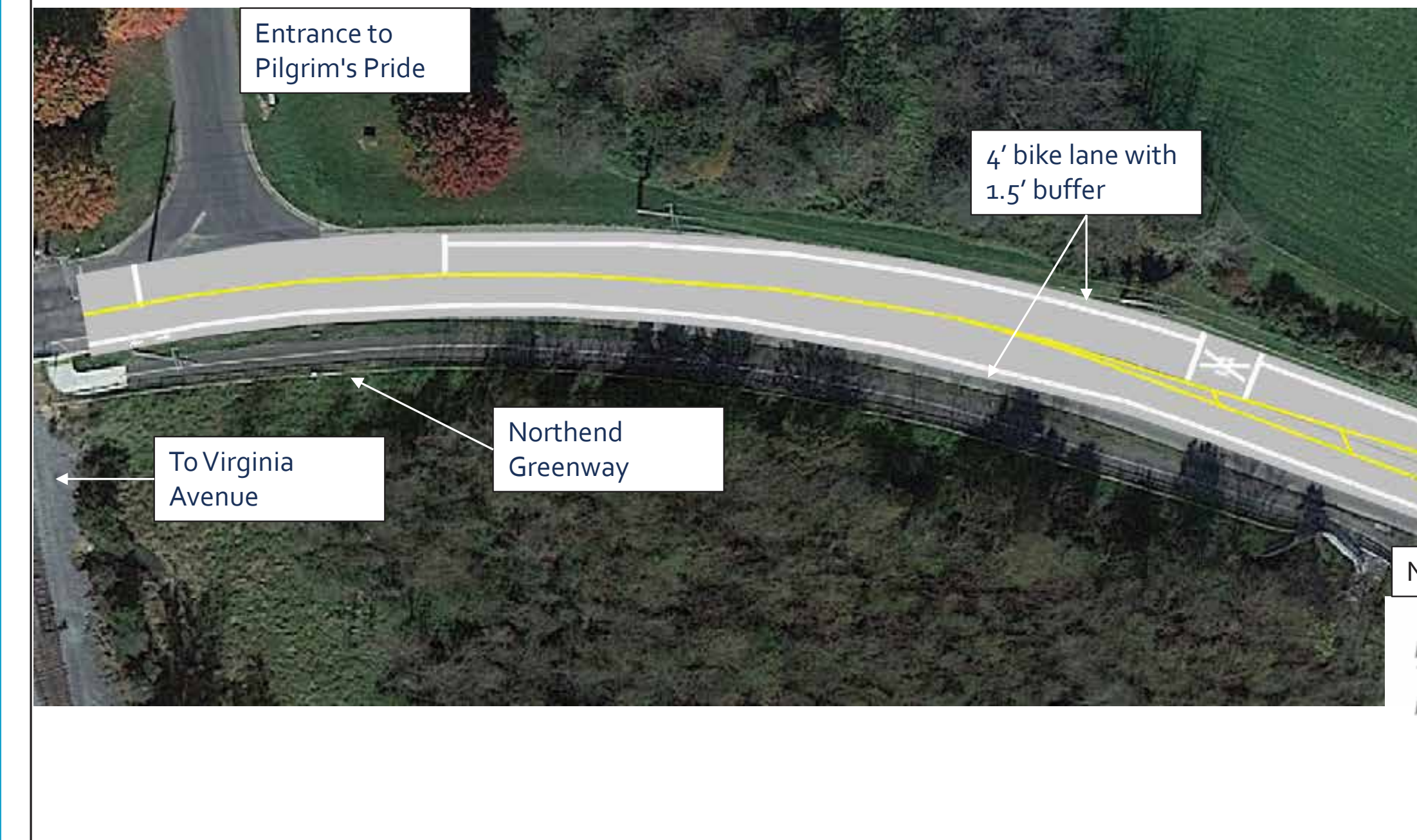

Mount Clinton Pike



Mount Clinton Pike

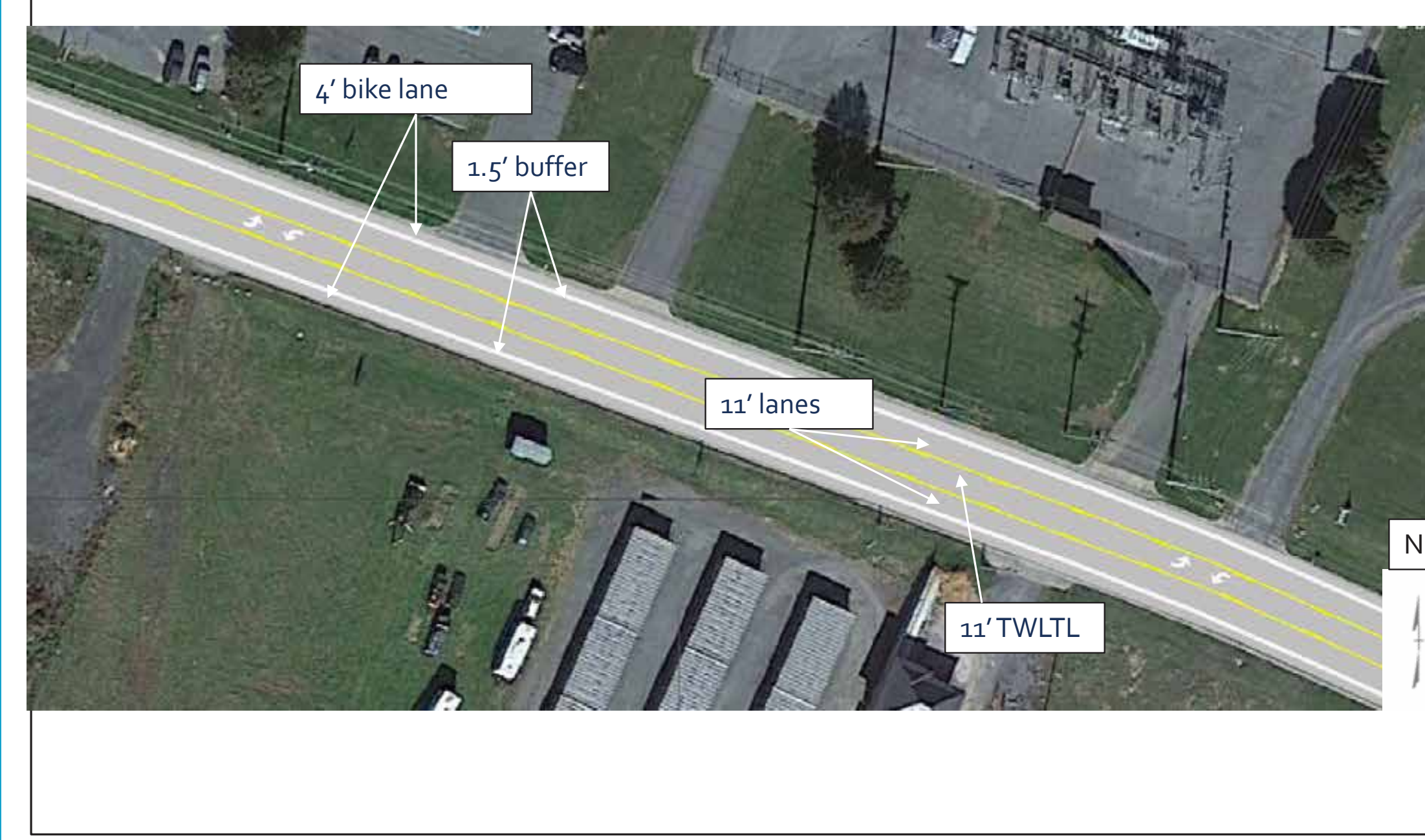

CONSIDERATIONS

- Extension of the reconfiguration to North Main Street will be considered in coming years when the road is repaved.
- Controls speeds by creating a single lane for through traffic.
- Reduces crashes caused by vehicles turning from the travel lane or weaving.
- Extends dedicated bicycle lanes for better connectivity.

EAST MARKET STREET ROAD RECONFIGURATION

EXISTING

East Market Street & Mason Street - Existing

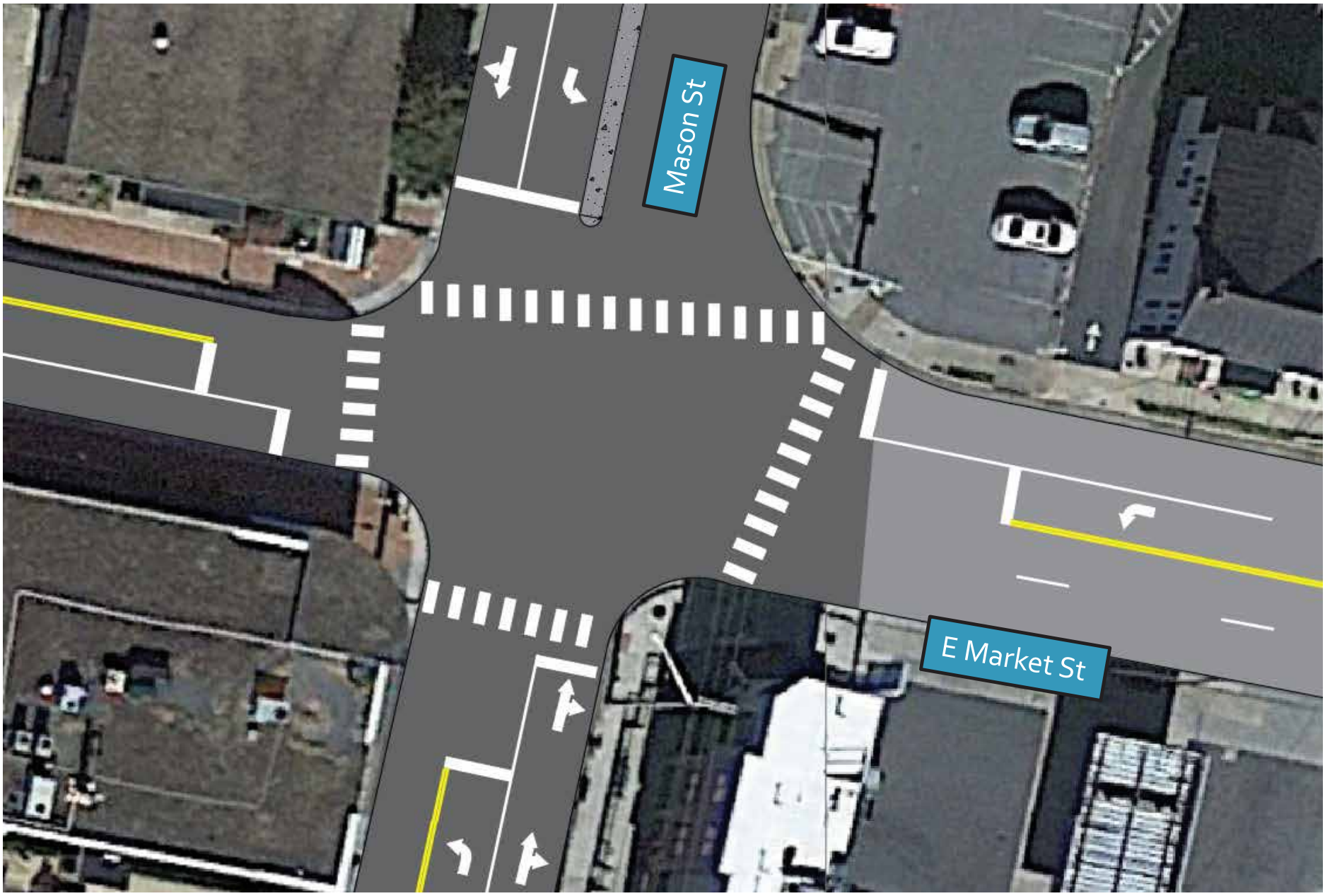

PLANNED

East Market Street & Mason Street - Planned

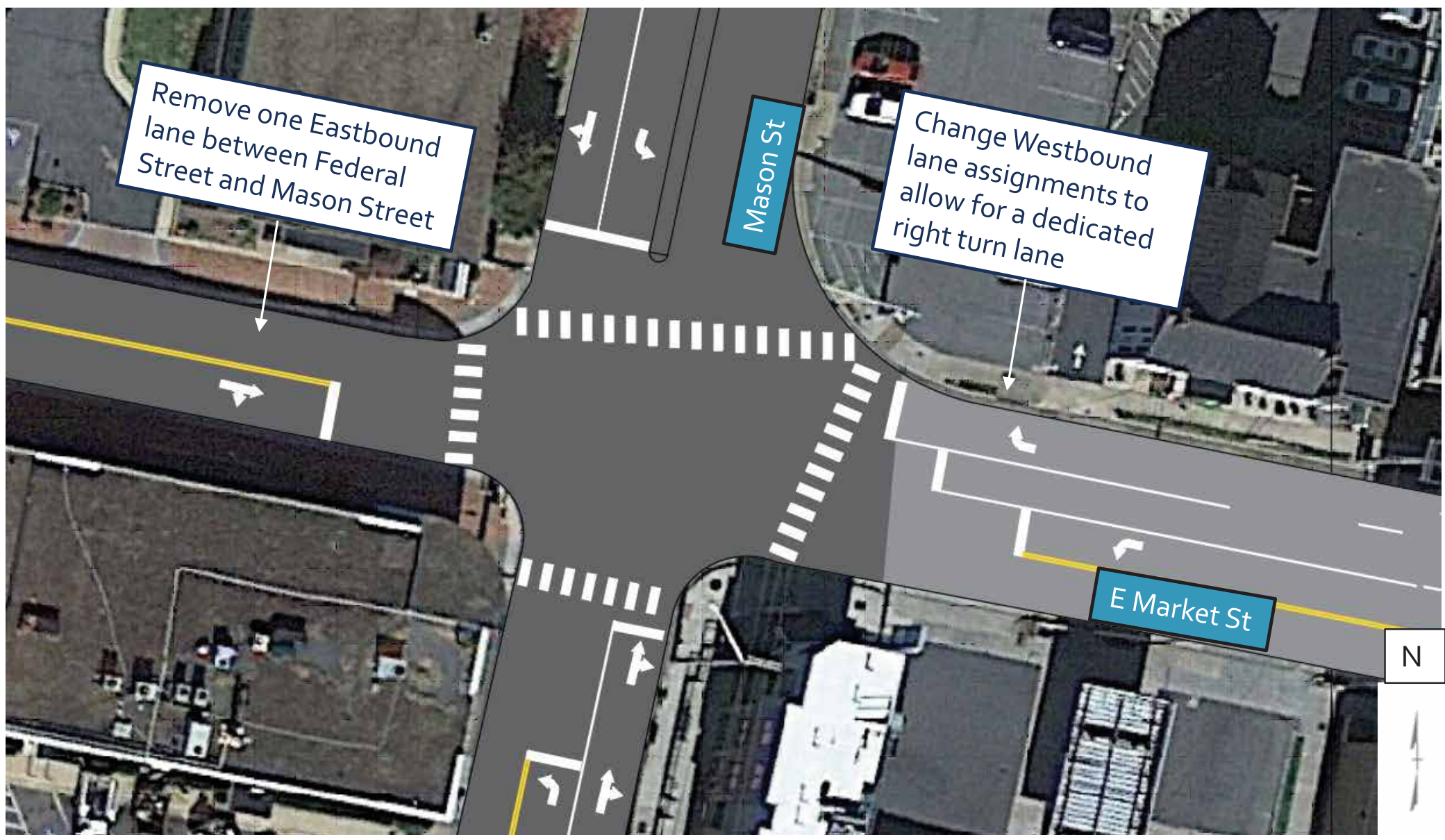

PLANNED

East Market Street Corridor



East Market Street & Broad Street

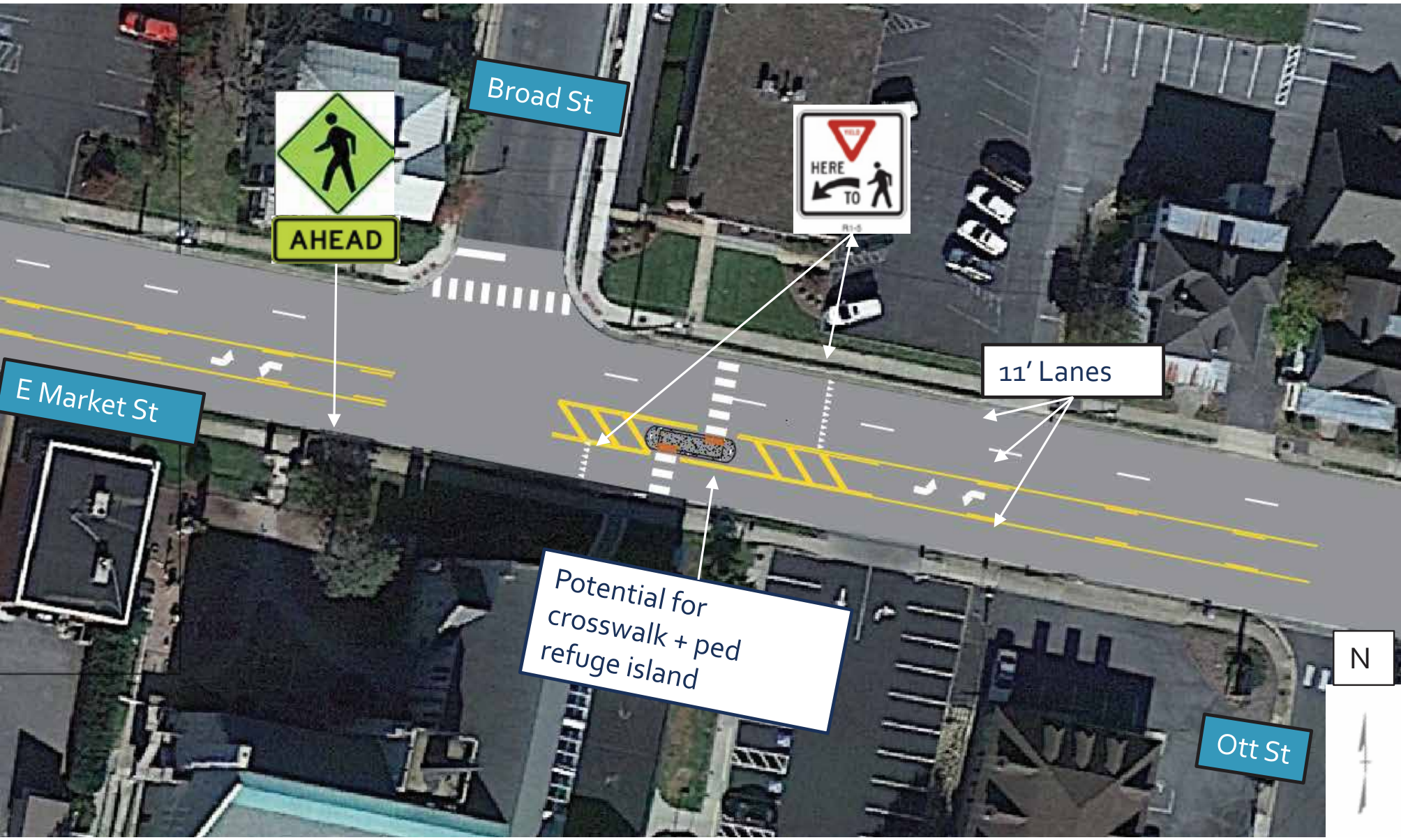

East Market Street & Broad Street

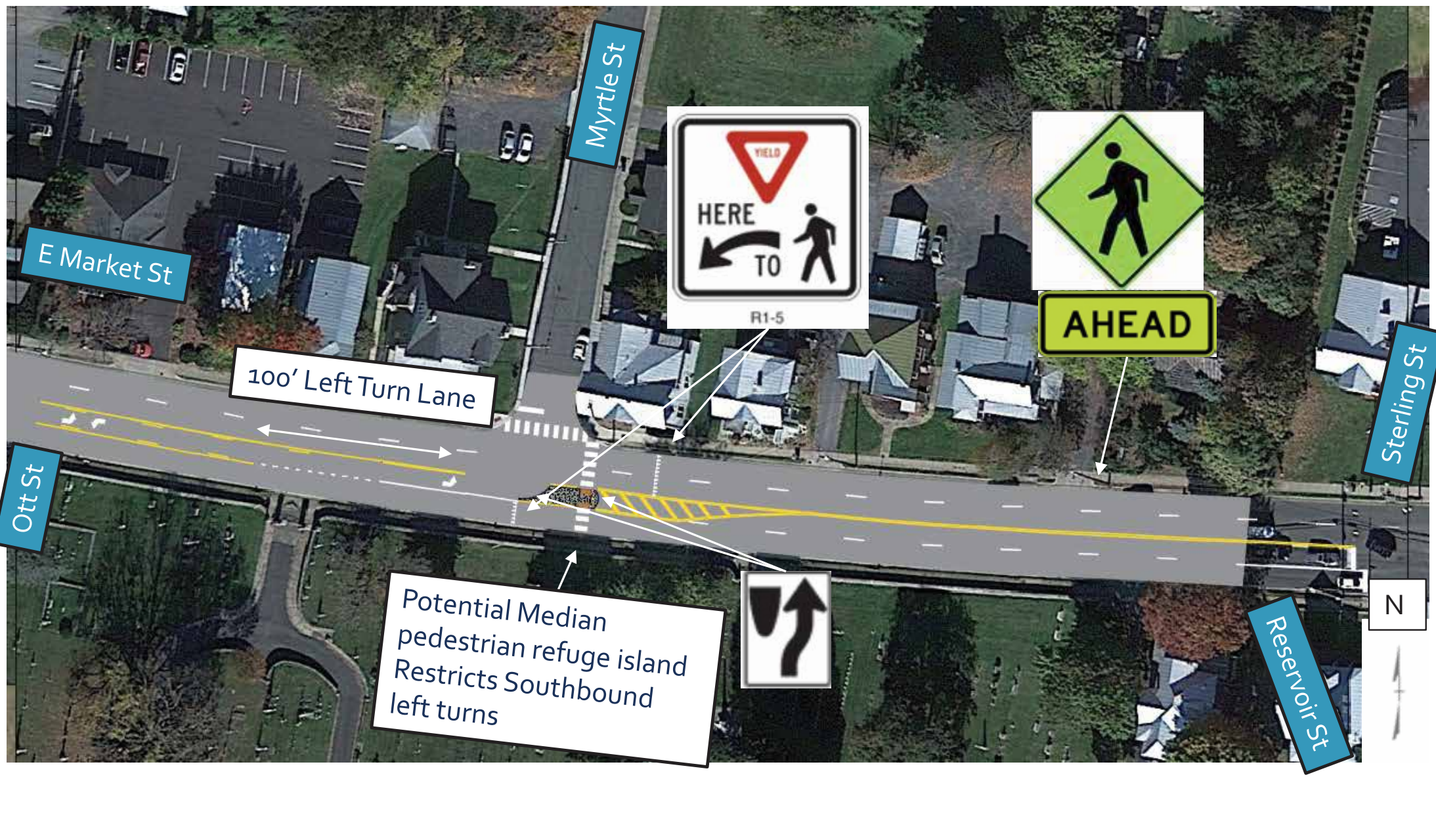

CONSIDERATIONS

- Controls speeds by creating a single lane for through traffic.
- Enhances the gateway to downtown by improving walkability and downtown access for pedestrians.
- Creates safer routes to schools for local students and their families, staff, and faculty.
- Improves East Market Street and Mason Street traffic signal operations.